



ONE

HIGH POWER LED LIGHTING SYSTEM
INSTRUCTION MANUAL



www.hopetech.com

MADE IN UK



SPECIFICATION



LUMEN OUTPUT



MAX POWER



WEIGHT



REGULATED
LIGHT OUTPUT



BEAM ANGLE



BURN TIME



POWER LEVELS

INTRODUCTION

The VISION 1 LED uses a single high power led providing up to 240 lumens of light output on max power. The versatility of being able to accept any AA (LR6) size battery cell gives you the option of achieving extended burn times in an extremely small package. With a regulated drive circuit you will always get the same level of light output regardless of what battery cell you use.

The multiple mounting options allow you to mount the light wherever you choose to use it, whether it be as a main bar mounted light, a helmet light or simply as a hand held flashlight.

SYSTEM COMPONENTS

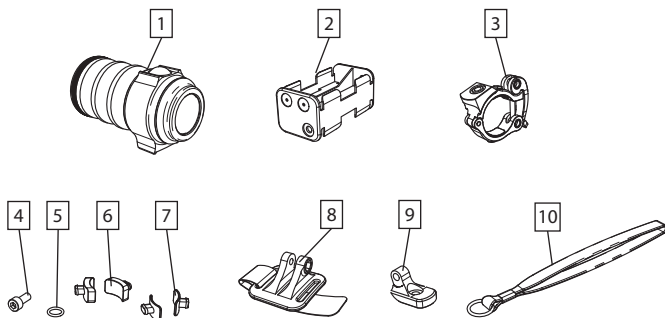

- | | |
|------------------------------|----------------------------------|
| 1. 1 LED lamp unit | 6. 25.4mm handlebar sleeves (x2) |
| 2. 4 x AA battery holder | 7. 31.8mm handlebar sleeves (x2) |
| 3. Universal handlebar clamp | 8. Helmet mount |
| 4. M5 x 12mm bolt | 9. Helmet mount adapter |
| 5. Handlebar clamp O-ring | 10. Wrist lanyard |

IMPORTANT INFORMATION

Please take time to read these instructions before use in order to familiarise yourself with the operation of the lighting system. We strongly advise you read the following recommendations in order to prevent injury or damage to the lighting system.

WARNING

- **This lighting system will withstand harsh wet weather conditions. However, it is not designed to be submersed in water. Please ensure that the light unit is removed from the bike before washing - particularly if using a high pressure jet wash.**
- **Do not look directly at the beam. Permanent eye damage could result. Consider other people when mounting the light on a helmet to avoid dazzling them.**
- **Keep this light away from children.**
- **This light unit can get hot when in use in maximum power mode. This is normal and should not be mistaken as a malfunction. Please use with caution.**
- **Unlike many other LED lighting systems, this light unit will suddenly shut down without any dimming of the light. Please bear this in mind when riding at night.**
- **This light unit does not incorporate a low battery warning mode due to the wide range of battery types that are compatible with the unit. It is therefore important to remember that the light unit will shutdown with no warning when the battery cells reach the cut-off voltage.**
- **Only use high quality disposable or rechargeable battery cells. When replacing discharged cells it is important to replace all four cells together. Do not mix old and new batteries or different battery types.**

FITTING INSTRUCTIONS

UNIVERSAL HANDLEBAR MOUNT

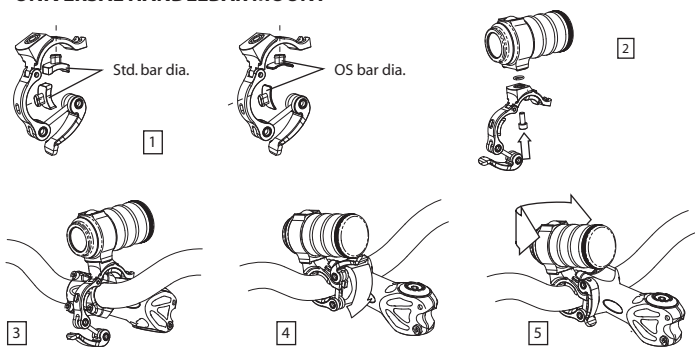

1. Select appropriate rubber plugs for your bar size and insert into location holes in the handlebar mount.
2. Attach mount to the light unit using the supplied M5 x 12mm bolt ensuring that the o-ring is located in the groove in the mount.
3. Attach mount to handlebar as close to the stem as possible.
4. Lock in place with the quick release lever.
5. Adjust the direction of the beam as required (up to 20° max adjustment).

HELMET MOUNT

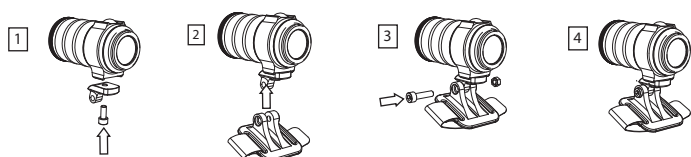

1. Attach the mount adapter to the light unit using the supplied M5 x 12mm bolt.
2. Slide the helmet mount over the mount adapter and align the bolt holes.
3. Secure in place using the supplied M5 x 20mm bolt and locknut whilst ensuring there is just enough freedom to adjust the tilt angle while riding if required.
4. Attach the mount to your helmet using the hook and loop strap.

WRIST LANYARD

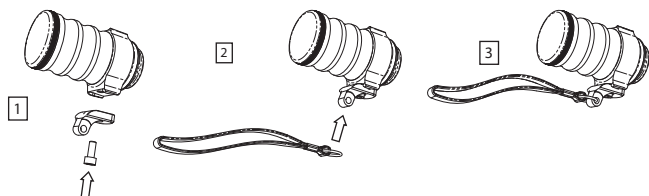

1. Attach the mount adapter to the light unit using the supplied M5 x 12mm bolt.
2. Thread the split ring of the wrist lanyard through the hole on the mount adapter.

REMOVING THE BATTERY HOLDER

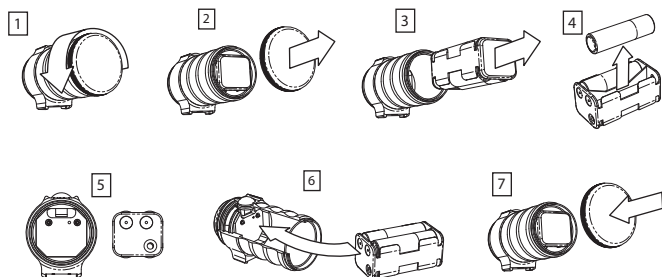

NOTE: When loading the battery holder into the light unit ensure the contact plates of the holder are aligned correctly with the spring contacts in the light unit as shown above.

We only recommend using good quality high capacity rechargeable or disposable battery cells since this light unit is a high drain device. Using poor quality low capacity standard alkaline cells will dramatically reduce the burn time of the light unit. The burn time charts opposite show a comparison between 2700mAh Ni-MH cells and single use Lithium cells (similar to those recommended for use in digital cameras) and are given as a guide only. Replace all four battery cells at the same time and do not mix battery types.

OPERATION OF THE LIGHT UNIT

CAUTION: Unlike many other LED lighting systems available, this light will suddenly switch off without any dimming of the LED. Please bear this in mind when riding at night.

With the light off:

- Press 1 – Turn light on in low power mode
 - Press 2 – Switch light into medium power mode
 - Press 3 – Switch light into high power mode
 - Press 4 – Switch light into max. power mode
 - Press 5 – Switch light into flash mode.
- Continue to cycle through power modes upon each press of the switch.
- Press and hold for 2 seconds to turn light off.

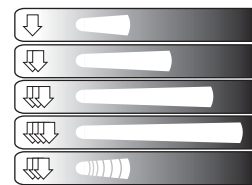

NOTE: We recommend that you utilise the full range of power modes during use in order to get the maximum burn time out of the battery, ie. Restrict your use of the maximum power level to a minimum and switch back down to a lower power level when you can.

BURN TIMES

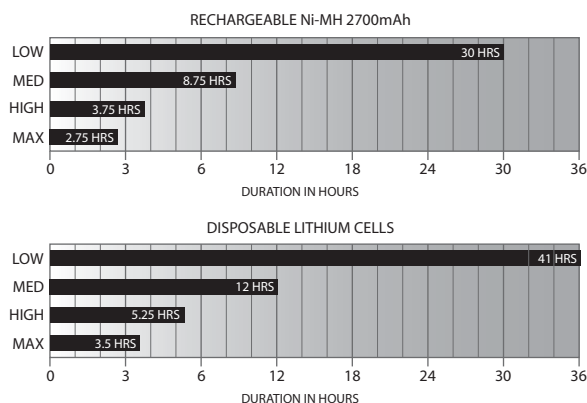

*Burn times stated have been tested in optimum conditions and may therefore vary from those times shown

MAINTENANCE

There are no serviceable parts inside the light unit. Please do not attempt to disassemble the unit other than removing the battery holder, as this will invalidate the warranty. If you find that there is a problem with the functioning of the light unit please first check that the batteries are fully charged and in good condition. If the light still fails to function please contact Hope Technology.

WARRANTY

All Hope Technology lighting systems are covered for one year from original date of purchase against manufacturer defects in material and workmanship. Proof of purchase is required. Product must be returned to Hope Technology to process any warranty claim.

This warranty does not cover any damage caused through mis-use or failing to comply by the recommendations given in this manual.

This warranty does not affect your statutory rights.